

**LEGEND**

- ELECTRICAL SERVICES SWITCHBOARD.
- SWITCHBOARD / CONTROL PANEL NOT PROVIDED AS PART OF THE ELECTRICAL SUBCONTRACT.
- SINGLE POWER OUTLET.
- DOUBLE POWER OUTLET.
- USB DOUBLE POWER OUTLET C/W USB CHARGER.
- DRINK FOUNTAIN OUTLET.
- CEILING SUSPENDED POWER OUTLET.
- ELECTRICAL FLOOR BOX, TYPE AS NOTED.
- SPECIAL PURPOSE POWER OUTLET.
- SINGLE PHASE ISOLATOR.
- THREE PHASE ISOLATOR.
- ELECTRICAL RISER / JUNCTION BOX AS NOTED.
- x DENOTES CONDUIT TYPE.
- PIT x□ ELECTRICAL PIT, TYPE AS NOTED.
- HD HAND DRYER CONNECTION.
- PD LIGHTING PRESENCE DETECTOR SWITCH.
- LCP LIGHTING CONTROL PANEL.
- SPx BMS SWITCH PANEL, TYPE AS NOTED.
- ONE-WAY LIGHT SWITCH.
- TWO-WAY LIGHT SWITCH.
- MANUAL DALI POT DIMMER.
- CIRCUIT LINE.
- SWITCH LINE.
- DB-x - Py POWER CIRCUIT DESIGNATION. DENOTES DB AND CIRCUIT.
- ELECTRICAL EQUIPMENT AS NOTED.
- RK OUTLET MOUNTED IN RECESS KIT.
- H HDMI OUTLET.
- RJ45 COMMUNICATIONS OUTLET.
- DOB DOOR BELL PUSH BUTTON.
- CH1 DOOR BELL CHIME.
- CR ACCESS CONTROL CARD READER.
- ES ACCESS CONTROL DOOR ELECTRIC STRIKE, TYPE AS NOTED.
- LIM ACCESS CONTROL LIFT INTERFACE MODULE.
- RSD ACCESS CONTROL ROLLER SHUTTER DOOR INTERFACE.
- AD ACCESS CONTROL AUTO DOOR INTERFACE.
- PB ACCESS CONTROL AUTO DOOR EXIT PUSH BUTTON.
- Security DIRECTIONAL MOTION DETECTOR.
- Security PIEZO SIREN.
- Security KEY PAD.
- Security OVER-RIDE SWITCH.

**LEGEND**

- SECURITY SIREN STROBE.
- PA HORN / HOOTER.
- RECESSED PA MULTI-TAP CONE SPEAKER.
- SURFACE MOUNTED PA MULTI-TAP CONE SPEAKER.
- M2 PRIVATE METER.
- FUSE.
- SINGLE PHASE.
- THREE PHASE.
- CURRENT TRANSFORMER C/W REMOVABLE LINK.
- FUSE LINK.
- COMBINED FUSE SWITCH.
- CIRCUIT BREAKER.
- ISOLATOR.
- RESIDUAL CURRENT DEVICE.
- CONTACTOR - NORMALLY OPEN.
- CONTACTOR - NORMALLY CLOSED.
- REFER TO DETAIL NOTED FOR THE AREA SHOWN HATCHED. ADDITIONAL OUTLETS & FITTINGS MAY BE SHOWN ON DETAIL.
- E1: GENERAL RECESSED LED EMERGENCY LIGHT. WHITE.
- E2: GENERAL WALL MOUNTED LED EMERGENCY LIGHT. WHITE.
- E3: WEATHERPROOF WALL MOUNTED LED EMERGENCY LIGHT.
- E4: GENERAL ROD SUSPENDED LED EMERGENCY LIGHT. BLACK.
- E5: GENERAL SURFACE MOUNTED LED EMERGENCY LIGHT. WHITE.
- EX: EMERGENCY LED EXIT LIGHT.
- EX WP: WEATHERPROOF EMERGENCY LED EXIT LIGHT.
- L1: 600 x 600 T-BAR MOUNTED LED FLAT PANEL.
- L2: 300 x 1200 T-BAR MOUNTED LED FLAT PANEL.
- L3: 1200 LONG SURFACE LED BATTEN C/W SENSOR.
- L4: GROUND LEVEL CIRCULATION SURFACE SQUARE DOWNLIGHT.
- L5: RECESSED AMENITY LED DOWNLIGHT.
- L6: SUSPENDED LINEAR EXTRUSION LIGHT.
- L7: SURFACE MOUNTED TRACK LIGHTING.
- L8: LEVEL 1 CIRCULATION RECESSED DOWNLIGHT.
- L9: INCUBATOR PENDANT.
- L10: WALL MOUNTED AREA LIGHT.
- L11: LED STRIP LIGHT.
- L12: RECESSED LED DOWNLIGHT.
- L13: KITCHENETTE OVERHEAD CUPBOARD STRIP LIGHT.
- L14: RECESSED ADJUSTABLE DOWNLIGHT.
- L15: SUSPENDED LINEAR EXTRUSION LIGHT.
- L16: OFFICE DESK OVERHEAD CUPBOARD STRIP LIGHT.

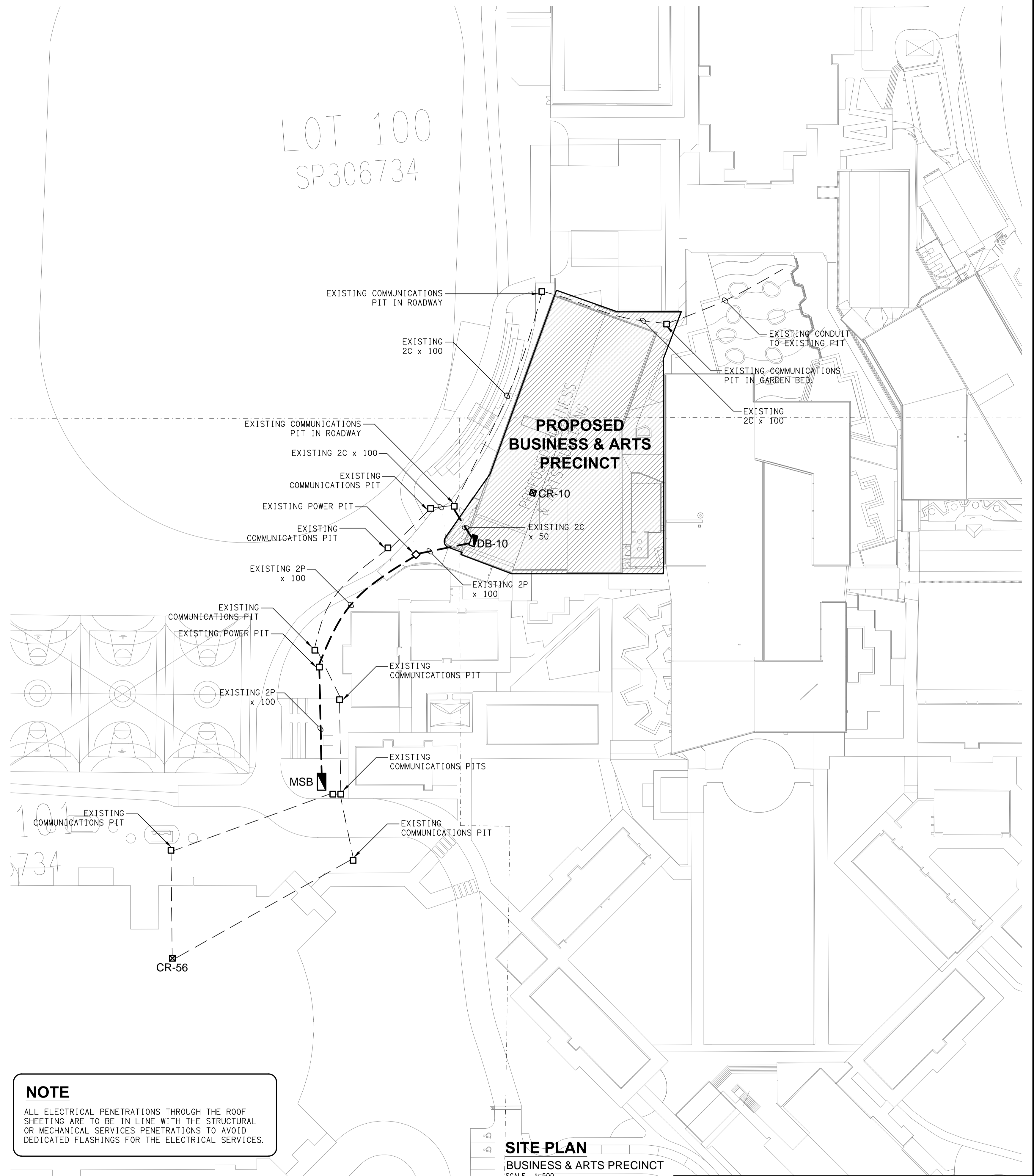

**NOTE**  
 ALL ELECTRICAL PENETRATIONS THROUGH THE ROOF SHEETING ARE TO BE IN LINE WITH THE STRUCTURAL OR MECHANICAL SERVICES PENETRATIONS TO AVOID DEDICATED FLASHINGS FOR THE ELECTRICAL SERVICES.

**SITE PLAN**  
 BUSINESS & ARTS PRECINCT  
 SCALE 1:500

ELECTRICAL DESIGN GROUP BRISBANE  
 PTY LTD  
 ACN 092 710 793  
 TRADING AS:  
 ELECTRICAL DESIGN GROUP

THE COPYRIGHT OF THIS DRAWING  
 REMAINS THE PROPERTY OF THE  
 ELECTRICAL DESIGN GROUP.  
 USE FIGURED DIMENSIONS  
 IN PREFERENCE TO SCALE.  
 ALL DIMENSIONS TO BE  
 VERIFIED ONSITE.

**ELECTRICAL DESIGN GROUP**  
 ELECTRICAL BUILDING SERVICES CONSULTANTS  
 BRISBANE GOLD COAST  
 P.O. Box 15, Sherwood Q.4075  
 Phone: (07) 3278 4375  
 Email: brisbane@edg.net.au  
 Web: www.edg.net.au

PROJECT:  
**ORMISTON COLLEGE  
 BUSINESS & ARTS PRECINCT**  
 97 DUNDAS STREET WEST, ORMISTON

C	TENDER	08/05/2026
REV.	DESCRIPTION:	DATE:
DRAWING: <b>ELECTRICAL SERVICES LEGEND &amp; SITE PLAN</b>		
SCALE: 1:500	AT A1	PROJECT NO: <b>C3666a</b>
		DRAWING NO: <b>E01</b>
		REVISION: <b>C</b>